

# masterplan

Housing Astana Axis, Astana

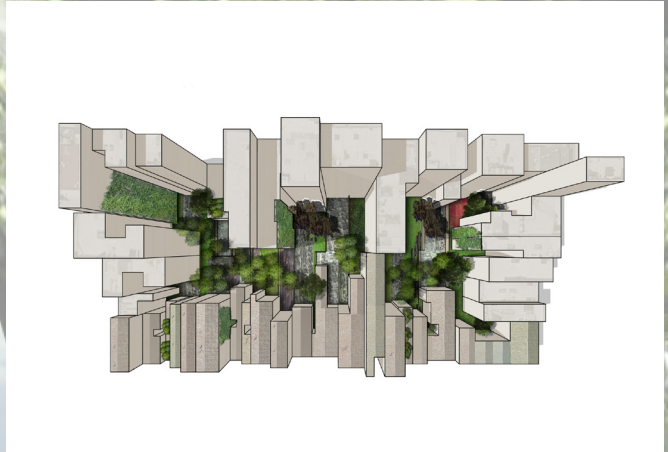



The Astana Axis project is situated along the extension of the government axis, east of the River Ishim in the Kazakh capital Astana. The client Alyansstroyinvest is a supporter of the government's program to create the new capital recently relocated from the former capital Almaty. The flat, semi-desert steppe landscape is currently occupied by small agrarian plots typical of left-over spaces in city centres, has little existing infrastructure and a high level of ground water. A Master plan has been designed for the new axis widening the central plot of the now under construction 'government axis' west of the river to 500m. This central and important zone/axis continues the idea of the 'government axis' by housing civic functions whilst the programme on either side is predominantly residential. Our site is comprised of 7 plots located to the north and south of the 'civic spine'. The 4 small plots to the north and 3 large blocks to the south are separated by the park and Palace of Culture. The client's objective was to provide housing, open space, retail and office space with some degree of flexibility for the middle market in Astana. The concept for the project was to introduce an urban quality to the site that would allow for greater diversity in living. The human scale of Amsterdam was a key component in creating the possibility of different qualities - eg. street life and the quality of living on the water. The Amsterdam plot was used as a basis from which to develop these varied conditions. For instance, the buildings facing the park adapt the Amsterdam model to a New York Central Park typology, creating a strong presence that serves to clearly define the park whilst maximising views for a higher percentage of apartments. Similarly in Amsterdam and New York, the development of the plot allows and encourages individuality that when combined create a greater whole. In keeping with the urban character and diversity, the programme includes housing, small scale retail, office, hotel, kindergarten, sports facilities, public squares and semi-private and private garden spaces. Materials will also reference the Amsterdam and New York typologies in the use of brick, with particular focus on the Amsterdam school. Once again, the theme of diversity underlines every aspect of this project in the search to create a vibrant environment.

**client**

Alyansstroyinvest

**project**

country: Kazakhstan

city: Astana

category: masterplan

status: design

gross floor area: ca. 225000 m<sup>2</sup>

design: 2007

completion: 2012

designed by  
*dijk van egeraat*